

SHERATON FAIRPLEX HOTEL
& CONFERENCE CENTER
601 W. McKinley Avenue
Pomona, CA 91768
t — 909 622 2220
f — 909 622 3577
sheraton.com/fairplex
www.fairplex.com



Sheraton Fairplex Hotel & Conference Center is located mere minutes from LA/Ontario International Airport, near the 10, 210, and 57 freeways, and many major businesses and attractions. Our new Conference Center provides an ideal venue for large gatherings of thousands with breakout session, classroom, and work-group meeting environments, to name a few. Our increased capacity allows us to accommodate larger groups than ever before, but we are also especially pleased with our smaller venues, which embody warmth, intimacy, and style perfectly suited for you and a handful of select invitees.

MEETING FACILITIES & SERVICES

- On-site convention kitchen
- High-speed Internet access in all meeting and public spaces
- 14,275 square feet of prefunction space
- Multiple residential seating areas for impromptu gatherings
- Personal meeting specialist
- Audiovisual equipment and on-site technicians

ROOM FACILITIES

- A total of 247 suites
- High-speed Internet access
- In-room movies
- Sheraton Sweet Sleeper™ Bed
- Refrigerator and microwave
- Shine by Bliss™ bath amenities

GUEST SERVICES

- Fitness facility
- Cyber café
- 24-hour front desk
- Car rental service
- Dry cleaning/laundry service
- Safe-deposit boxes
- Floral service
- Disabled-accessible facilities
- Airport transportation (limited)
- Gift shop
- Whirlpool
- Parking for large-scale events
- Heated outdoor pool
- Sauna
- Golf course nearby

GATHER OVER A MEAL

- McKinley's Bar
- McKinley's Grille
- In-room dining
- Gourmet catering on- and off-site
- Cyber café

NEARBY THINGS TO SEE AND DO

- Angel Stadium
- Dodger Stadium
- Pomona Valley Medical Center
- University of La Verne
- Western University
- Cal Poly Pomona
- Claremont McKenna College
- Scripps College
- Ontario Convention Center
- Bausch and Lomb
- Lockheed Martin
- Casablanca Fan Company
- The Boeing Company
- Disneyland® Resort
- Ontario Mills Mall
- Victoria Gardens

welcome
TO
Sheraton Fairplex
Hotel & Conference
Center. A winning
combination of
comfort, location,
value, and style, just
a short distance
from LA/Ontario
International Airport.

MEETINGS AND EVENTS

MEETINGS

Situated in the 543-acre Fairplex Exposition Complex, home of the Los Angeles County Fair, Sheraton Fairplex Hotel & Conference Center offers a convenient location—with easy access to Los Angeles, San Bernardino, and Orange counties—and a serene park-like setting that inspires creative, productive thinking.

While it's true we're well-versed when it comes to accommodating larger events, the real beauty of our new space lies in its versatility. In addition to banquet halls and show floors, there are also impressive intimate venues throughout. Whatever your group size, we offer the perfect setting when style matters—as each tablecloth and light fixture has been chosen specifically by our meeting and event specialists to meet the perfect balance of elegance and comfort.

EVENTS

With more than 47,000 square feet of new meeting space, it's pretty obvious that we believe guest lists should go untrimmed. When it comes to hosting the largest of large-scale functions, you'd have to look far and wide to find facilities that rival those of Sheraton Fairplex Hotel & Conference Center.

Whether you need a show floor with plenty of room for trade booths or you're looking for a ballroom where you and your lucky guests can celebrate within a sophisticated décor, our world-class facilities and contemporary surroundings will ensure a successful and memorable event. Not to mention our incredibly accommodating meeting experts; they really know how to throw a party on a grand scale.

SOUTHERN CALIFORNIA



CONFERENCE CENTER

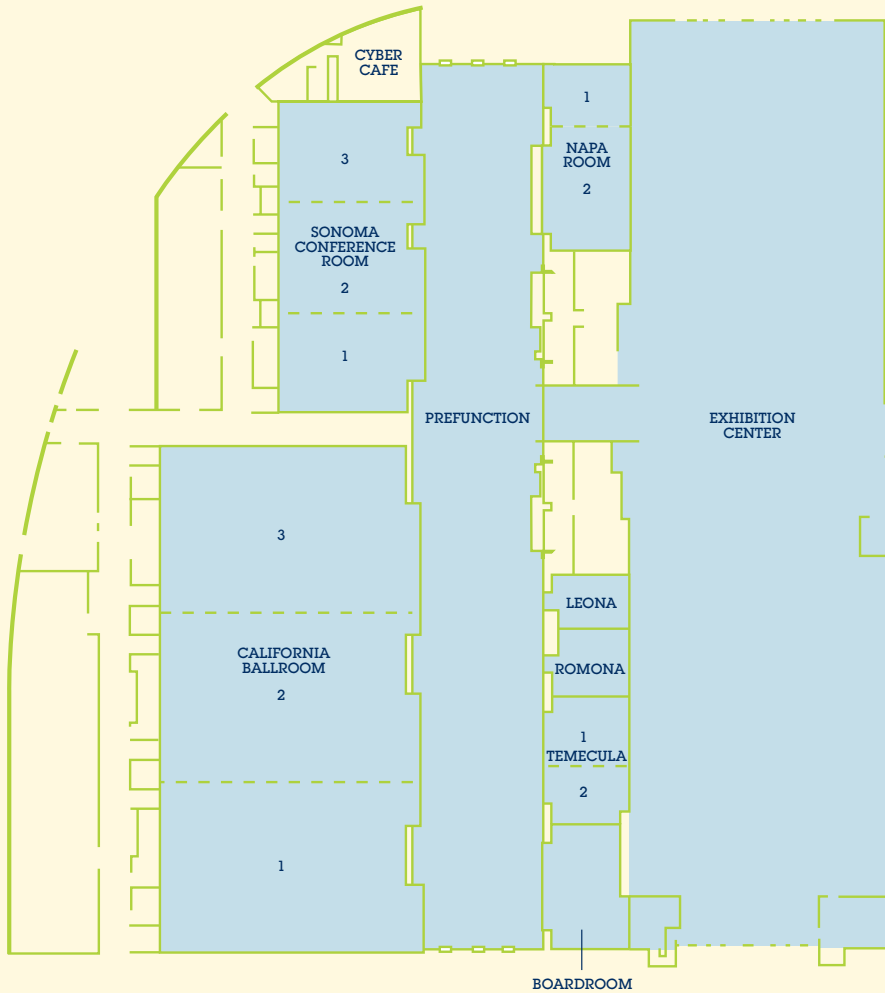

HOTEL

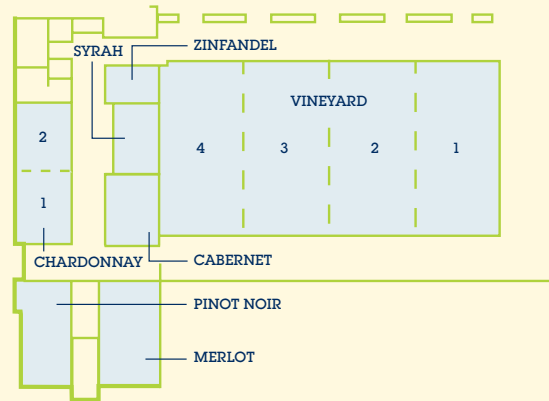

ROOM DIMENSIONS AND SEATING CAPACITY-HOTEL

Room Name	Square Feet	Dimensions	Height	Banquet	Theater	Reception	Classroom	U-Shape	Square	Conference
ZINFANDEL	207	19' x 11'	9'	—	—	—	—	—	—	6
SYRAH	294	21' x 14'	9'	—	—	—	—	—	—	10
CABERNET	386	21' x 17'	9'	24	30	30	16	12	14	14
CHARDONNAY	851	43' x 19'	9'	50	80	70	40	30	32	32
CHARDONNAY 1	421	21' x 19'	9'	24	80	30	16	12	14	14
CHARDONNAY 2	425	21' x 19'	9'	24	40	30	16	12	14	14
MERLOT	615	31' x 20'	9'	50	60	50	32	20	22	22
PINOT NOIR	628	33' x 19'	9'	50	60	50	32	20	22	22
VINEYARD BALLROOM	6,222	56' x 112'	12'	450	750	600	320	—	—	36
VINEYARD 1, 2, 3, 4	1,560	56' x 28'	12'	100	150	90	70	40	40	36
AVALON BALLROOM (OFF-SITE)	6,721	47' x 143'	14'	500	800	700	380	—	—	—

ROOM DIMENSIONS AND SEATING CAPACITY-CONFERENCE CENTER

CALIFORNIA BALLROOM	12,460	159' x 78'	21.8'	1,000	1,311	1,384	712	415	415	415
CALIFORNIA 1	4,147	53' x 78'	21.8'	365	499	527	271	158	158	158
CALIFORNIA 2	4,166	53' x 78'	21.8'	320	438	462	238	138	138	138
CALIFORNIA 3	4,147	53' x 78'	21.8'	319	436	460	236	134	134	134
SONOMA CONFERENCE ROOM	4,032	96' x 42'	13'	310	424	448	230	134	134	134
SONOMA 1, 2, 3	1,344	32' x 42'	13'	103	141	149	76	44	44	44
BOARDROOM	949	37' x 26'	10'	—	—	—	—	—	—	31
TEMECULA	1,021	38' x 54'	10'	78	106	112	58	32	32	32
TEMECULA 1	508	19' x 27'	10'	39	53	56	29	16	16	16
TEMECULA 2	513	19' x 27'	10'	39	54	57	29	17	17	17
ROMONA	578	21' x 27'	10'	44	60	64	33	19	19	19
LEONA	407	15' x 27'	10'	31	42	45	23	13	13	13
NAPA ROOM	1,539	57' x 27'	10'	39	54	57	29	17	17	17
NAPA ROOM 1	513	19' x 27'	10'	39	54	57	29	17	17	17
NAPA ROOM 2	1,026	38' x 27'	10'	78	108	114	58	34	34	34
PREFUNCTION	9,108	33' x 276'	10'	700	—	1,012	—	—	—	—
EXHIBITION CENTER	33,600	100' x 318'	21'	2,800	3,500	3,700	—	—	—	—